

# WATER RESISTANT HANGING AM/FM SHOWER RADIO

31288c  
**Elpine**<sup>TM</sup>  
A NAME YOU CAN TRUST!

## PRODUCT USE, CARE AND SERVICE WARRANTY INSTRUCTIONS. READ AND SAVE THESE INSTRUCTIONS

### OPERATING INSTRUCTIONS

1. Hook
2. AM/FM Selector
3. Tuning knob
4. Battery Door (Rear)
5. ON/OFF Volume knob
6. Speaker

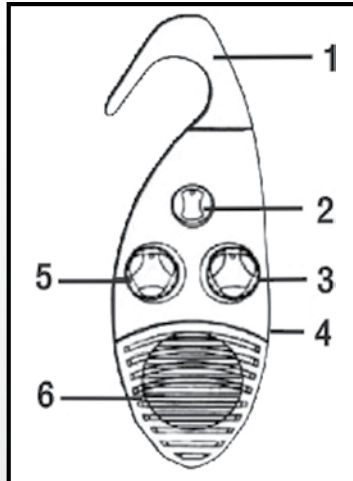

Images are for illustration purpose only.  
Actual product may differ from pictures.

### INSTALLING BATTERIES

1. Rotate the screw located on the rear of the radio in a counter clockwise direction and remove the head cover first, then open the battery door (4) - see below diagram.
2. Install the 3x "AA" size batteries (not included) following the polarity diagram in the battery compartment.
3. Replace the battery door and cover, and then tighten the screw in a clockwise direction.

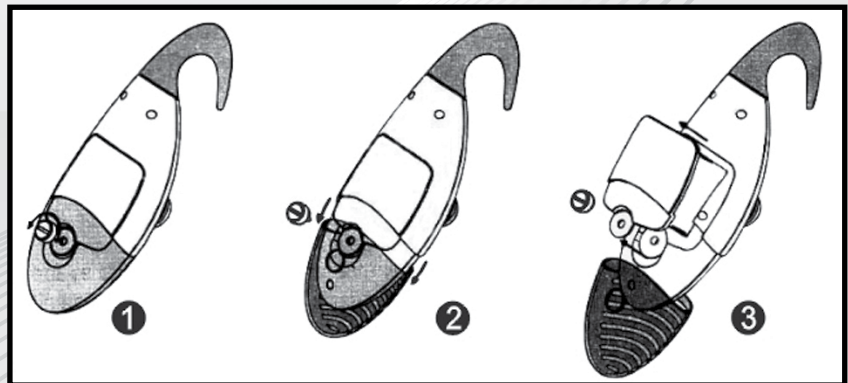

### RADIO OPERATION

1. Rotate the ON/OFF Volume knob (5) clockwise to turn the radio "ON". Adjust the volume control to your required sound level.
2. Set the AM/FM selector (2) to either AM (MW) or FM broadcasts.
3. Rotate the Tuning Knob (3) to the desired station.
4. To turn the radio off, rotate the ON/OFF Volume control(5) counter clockwise until a clicking sound is heard.

### Important

Do not mix old and new batteries. Do not mix alkaline, standard or rechargeable batteries. Weak batteries can leak and severely damage your radio. Always remove batteries when the radio is not used for a long time.

### **WARNING**

- Do not immerse in water. This shower radio is splash resistant only.
- Do not drop as this may cause damage to the case.
- Do not disassemble this product, which may damage splash proof parts.



Elpine B20 3BT