

# INSTRUCTION MANUAL

Read all the instruction carefully before you use the appliance and keep it for future use.

67030c



**MARKSMAN**  
QUALITY TOOLS

## 350W JIG SAW



- 230V~50Hz
- 350w
- 3000 RPM
- 55(6)MM

5 AMP fuse (max)  
must be fitted to plug  
attached to this cable.



MARKSMAN B20 3BT UK

**JIG SAW**

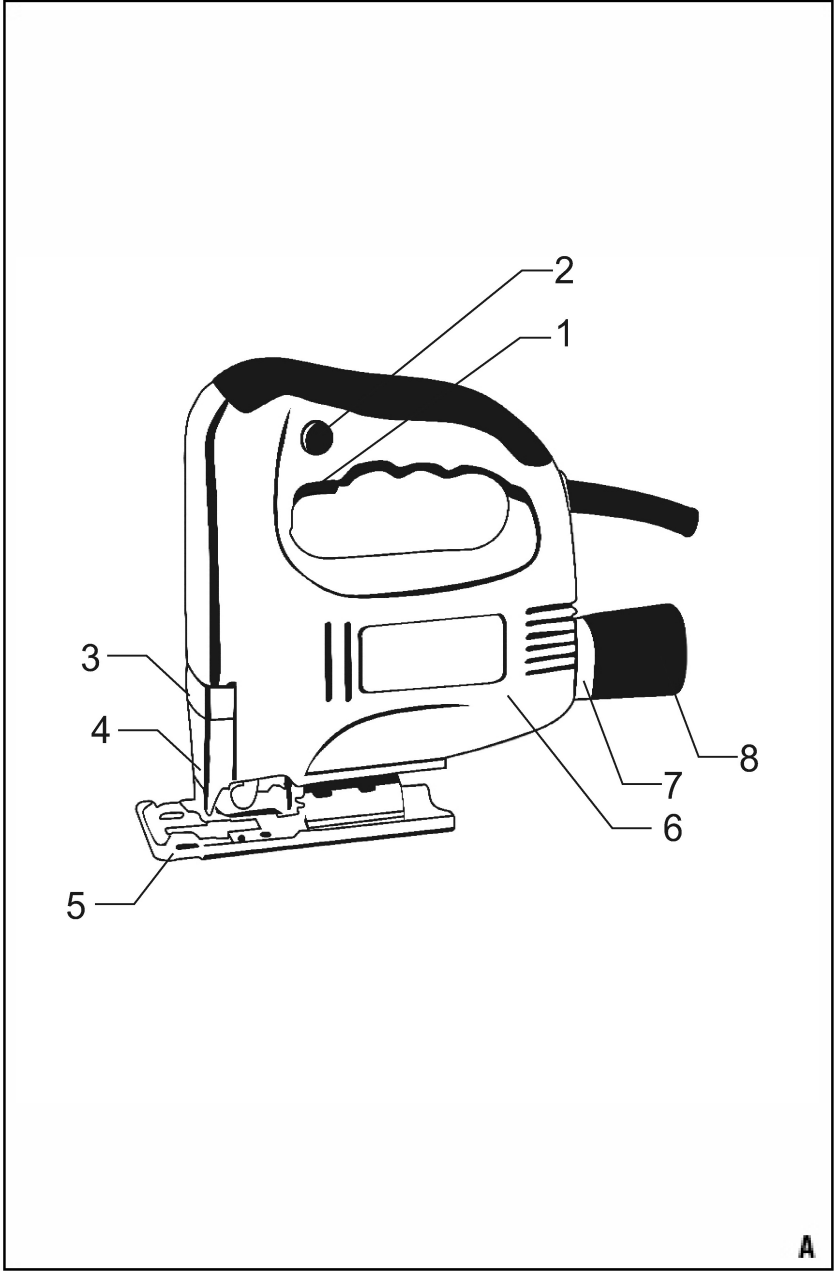

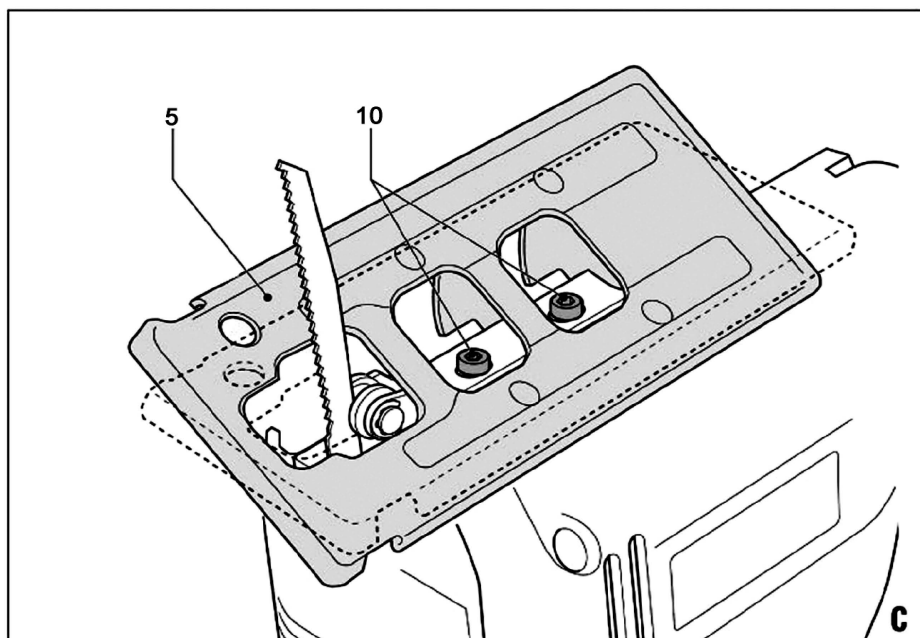
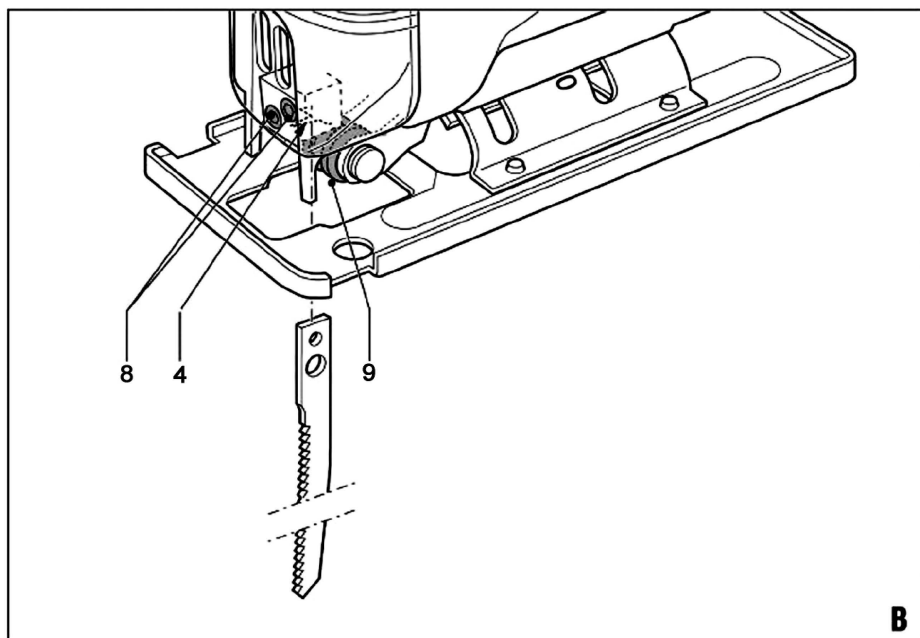

## **WARNING:**

Read this manual carefully before using the machine, for your own safety.

## **SAFETY INSTRUCTIONS**

When using the machine, always observe the enclosed safety instructions as well as the additional safety instructions. The following symbols are used throughout this manual:



**Denotes risk of personal injury or damage to the tool.**

## **ADDITIONAL SAFETY INSTRUCTIONS FOR JIG SAWS**

- Make sure that the saw blade is mounted correctly before use.
- Make sure that, when in use, the guard is pressed down as far as possible.
- Never load the machine so much that the motor is coming to a standstill.
- Never try to brake the saw blade after the machine has been switched off.
- Use original accessories only.

## **ELECTRICAL SAFETY**



**Always check that the power supply corresponds to the voltage on the rating plate.**

## **DESCRIPTION (fig. A)**

Your jigsaw has been designed for sawing wood, metal and plastics.

1. On/off switch
2. Lock button
3. Safety guard
4. Saw blade holder
5. Shoe
6. Allen key holder
7. Dust extraction connector

## **Mounting saw blades (fig. B)**

The opening in the saw blade holder (4) must be clean and free from saw dust.

- Loosen the set screws ( 8 ).
- Slide the saw blade up to the stop in the saw blade holder (4). Make sure that the back of the saw blade engages in the slot of the guide roller ( 9 ).
- Tighten the set screws ( 8 ) firmly.



The set screws ( 8 ) may loosen during use by vibration and damage the saw blade. Regularly check that the saw blade is fastened firmly and if necessary fasten the set screws. Only carry out this inspection when the machine has been switched off, the plug has been removed from the wall socket and the saw blade has come to a stand still!

Sharp saw blades produce the best result. Replace worn saw blades on time by new ones. Remember that continuous use of worn saw blades reduces the accuracy of the machine and may lead to overloading the motor!

### **Cutting of mitre angles (fig. C)**

The max. mitre angle to the left/right is 45°.

- Loosen the set screws (10).
- Tilt the shoe (5) to the required mitre angle.
- Tighten the set screws (10) firmly.

### **Using the dust extraction connection (fig. A)**

The dust extraction (7) together with an external vacuum cleaner takes care of the dust extraction of the working surface.

- Connect a domestic vacuum cleaner to the machine.

### **Switching on and off (fig. A)**

- To switch on the machine press the on/off switch (1).
- To switch off the machine, release the on/off switch (1).
- To switch the machine to continuous mode, you keep the on/off switch (1) fully pressed and simultaneously press the lock button (2). And subsequently release the on/off switch.
- To switch off continuous mode, press the on/off switch (1) again.



When sawing metal always use a coolant (for example oil or water) to prevent the machine and work piece from overheating.

### **Lubrication (fig. B)**

Regularly apply a drop of oil to lubricate the guide roller ( 9 ).

## **CLEANING AND MAINTENANCE**

The machine does not require any special maintenance.

Regularly clean the ventilation slots.

## **TECHNICAL DATA**

Mains voltage	230 V
Mains frequency	50 Hz
Power input	350 W
No load speed	3000rpm
Max. cutting depth	wood 55 mm    steel 6 mm
Mitre angle	0±45°

## SAFETY INSTRUCTIONS

**Warning!** When using electric tools, basic safety precautions should always be followed to reduce the risk of fire, electric shock and personal injury, including the following. Read all these instructions before attempting to operate this product and save these instructions.

### For safe operation:

- 01. Keep work area clean** - Cluttered areas and benches invite injuries.
- 02. Consider work area environment** - Don't expose power tools to rain. Don't use power tools in damp or wet locations. Keep work area well lit. Don't use power tools in presence of flammable liquids or gases.
- 03. Guard against electric shock** - Prevent body contact with earth surfaces (e.g. pipes, radiators, ranges refrigerators)
- 04. Keep children away** - Do not let visitors contact tool or extension cord. All visitors should be kept away from work area.
- 05. Store idle Tools** - When not in use, tools should be stored in dry, high, or locked-up place, out of the reach of children.
- 06. Don't force tool** - It will do the job better and safer at the rate for which it was intended.
- 07. Use the right tool** - Don't force small tools or attachments to do the job of heavy duty tool. Don't use tools for purposes not intended for example, don't use circular saw for cutting tree limbs or logs.
- 08. Dress properly** - Do not wear loose clothing or jewellery. They can be caught in moving parts. Rubber gloves and nonskid footwear are recommended when working outdoors. Wear protective hair covering to contain long hair.
- 09. Use safety glasses** - Also use face or dust mask if cutting operation is dusty.
- 10. Do not abuse the cord** - Never Carry tool by cord or yank it to disconnect it from receptacle, Keep cord from heat, oil and sharp edges.
- 11. Secure work** - Use clamps or a vice to hold work, it's safer than using your hand and it frees both hands to operate tool.
- 12. Do not overreach** - Keep proper footing and balance at all times.
- 13. Maintain tools with care** - Keep tools sharp and clean for better and safer performance. Follow instructions for lubricating and changing accessories. Inspect tool cords periodically and if damaged, have repaired by authorised service facility. Inspect extension cords periodically and replace if damaged. Keep handles dry, clean and free from oil and grease.
- 14. Disconnect tools** - When not in use, before servicing, and when changing accessories such as blades, bits and cutters.
- 15. Remove adjusting keys and wrenches** - Form the habit of checking to see that keys and adjusting wrenches are removed from tool before turning it on.
- 16. Avoid unintentional starting** - Don't Carry plugged-in tool with finger on switch. Be sure switch is off when plugging in.
- 17. Outdoor use extension cords** - When tool is used outdoors, use only extension cords intended for use outdoors and so marked.
- 18. Stay alert** - Watch what you are doing, Use common sense. Do not operate tool when you are tired.
- 19. Check damaged parts** - Before further use of the tool, a guard or other part that is damaged should be carefully checked to determine that it will operate properly and perform its intended function. Check for alignment of moving parts, binding of moving parts, breakage of parts, mounting, and any other conditions that may affect its operation.

- A guard or other part that is damaged should be properly repaired or replaced by an authorised service centre unless otherwise indicated elsewhere in this instruction manual. Have defective switches replaced by an authorised service centre. Do not use tool if switch does not turn it on and off.

- 20. Warning** - The use of any other accessory or attachment other than that recommended in this operating instruction might present a risk of personal injury.
- 21. Have your tool repaired by an expert** - This electric appliance is in accordance with the relevant safety rules. Only experts may carry out repairing of electric appliances otherwise it may cause considerable danger for the user.
- 22. connect the dust extraction device** - Wherever there are facilities for fitting a dust extraction system, make sure it is connected and used.
- 23. Noise level** - The noise level of this power tool is measured according to IEC 59 co 11, IEC 704, DIN 45635 Part 21, NFS 31081 (84/537IEWG). Noise level at work area can exceed 85 dB (A). In that case operators should protect themselves against damage to hearing - wear ear defenders.

**WARNING:**

**THIS PRODUCT OPERATES AT 230 VOLT AC SINGLE PHASE MAINS VOLTAGE.  
READ ALL THE SAFETY INSTRUCTIONS BEFORE USING THE MACHINERY.  
OBSERVE ALL THE LOCAL SAFETY REGULATIONS.**

This product is "CE" marked and complies with all the relevant European CE directives for LVD, EMC and Machinery safety.



## UK PLUG REWIRING

Your appliance operates on 230-240V-50Hz AC Mains and comes fitted with a 5-pin BSI Approved plug, so that it is ready for use by simply plugging into AC Mains. Should you need to change or refit a plug, proceed as follows:

### IMPORTANT:

The wires in the mains lead are coloured in accordance with the following code:

BLUE : NEUTRAL (N)

Brown or RED : LIVE (L)

As the colours of the wires in the mains lead of this appliance may not correspond with the coloured markings identifying the terminals in you plug, proceed as follows:

The wire which is coloured BLUE must be connected to the terminal which is marked with the letter "N" or coloured BLACK.

The wire which is coloured BROWN must be connected to the terminal which is marked with the letter "L" or coloured RED.

Always ensure that the Mains Cord is located into the Plug through the Cord Guard or Cable Clamp, and that the Cord Guard screws are lightened to clamp the Cord (outer sheath and inner coloured wires) in position in the Plug. Make sure the Plug top is also fitted securely.

This appliance must be protected by a 5-amp fuse in a 5-amp type (BS1363) plug. Should you need to replace the fuse, use only an ASTA approved BS 1362 fuse.

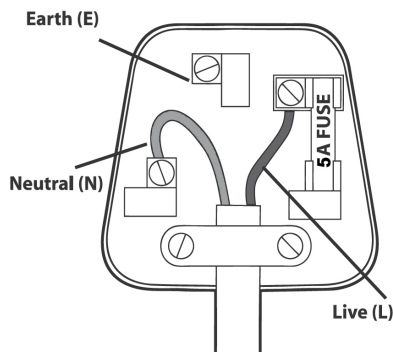





#### **CORRECT DISPOSAL OF THIS PRODUCT**

This marking indicates that this product should not be disposed with other household wastes throughout the EU. To prevent possible harm to the environment or human health from uncontrolled waste disposal, recycle it responsibly to promote the sustainable reuse of material resources. To return your used device, please use the return and collection systems or contact the retailer where the product was purchased. They can take this product for environmental safe recycling.

# **350W JIG SAW**



MARKSMAN B20 3BT UK

67030c



**MARKSMAN**  
QUALITY TOOLS