

# INSTRUCTION MANUAL

81231c  
**ROADSTER**  
*Car Accessories*  
*Quality - that is streets ahead...*

## REAR BICYCLE CARRIER



5 038673 812311

ROADSTER B20 3BT UK

Thank you for purchasing this Roadster Cycle Carrier. This product will, if used according to these instructions and correctly maintained, give you years of trouble free use.

**PLEASE READ THESE INSTRUCTIONS CAREFULLY. USE THE PRODUCT CORRECTLY AND WITH CARE FOR THE PURPOSE FOR WHICH IT IS INTENDED. FAILURE TO DO SO MAY CAUSE DAMAGE OR PERSONAL INJURY. PLEASE KEEP INSTRUCTIONS SAFE FOR FUTURE USE.**

## **1. SAFETY INSTRUCTIONS**

- **WARNING!** Due to the variety in design of vehicles and cycles, it is the user's full responsibility to ensure no damage occurs whilst using this cycle carrier. Correct attachment of carrier to a vehicle is therefore critical and is beyond control of the manufacturer, distributor or supplier.
- **WARNING!** The user must secure the carrier and any cycles to be carried properly, checking the security frequently when in use.
- Every time before use check the carrier for security of fittings or any sign of wear and tear. Replace any worn or damaged parts.
- **DO NOT** use the cycle carrier if any parts are missing or damaged as this may cause failure and/or personal injury.
- Where additional ties are required, use strong, good quality tie restraints for securing cycles to the carrier. **DO NOT** use string, or elasticated straps.
- If the load obscures the vehicle registration plate or lights fit an auxiliary number plate and/or lighting system.
- Avoid damage caused by hot exhaust fumes. **DO NOT** position cycles directly next to the vehicle's exhaust, especially the bicycle tyres. If necessary fit an exhaust deflector.
- Ensure that bicycles do not come into contact with the vehicle bodywork and provide protection as required.
- For hatchbacks and estate vehicles ensure the foam protection pads make contact with glass if the carrier's arms rest on the rear window.
- For hatchback vehicles with glass edges you must ensure the glass is protected by some form of rubber strip or pad.
- This carrier is designed to carry 2/3 cycles. Check the vehicle manufacturer's specification to ensure that you do not overload the rear hatch door.
- **WARNING!** Remove any loose objects from the cycles i.e pumps, bottles etc.
- **WARNING!** Avoid any protrusions beyond the side of the car as these may present a risk of injury to passers-by.
- **DO NOT** use the cycle carrier for any purpose other than for which it is designed.
- **DO NOT** strap any other items to the carrier, only bicycles.
- **WARNING!** Drive carefully - Be aware of cross winds, sudden braking or hard cornering, reduce speed accordingly when using carrier.
- **WARNING!** This carrier is designed for temporary use only, remove when not in use or before going through a car wash.
- **WARNING! REMEMBER THE DRIVER OF THE VEHICLE IS RESPONSIBLE FOR THE SECURITY AND SAFETY OF THE LOAD CARRIED.**

## **2. CONTENTS CYCLE CARRIER PARTS**

1. MAIN FRAME (PART ASSEMBLED)
2. FIXING STRAPS X 6
3. FIXING BOLTS WITH WASHER AND NUT X 2 SETS
4. BLACK PLASTIC STRAP FIXINGS X 4
5. METAL MOUNTING CLAMPS X 4

### 3. CARRIER ASSEMBLY

Unpack product and check contents against the contents list. Should there be any damaged or missing parts contact your supplier immediately.

- 3.1 The cycle carrier's main frame comes part assembled and folded flat.
- 3.2 The side and bottom mounting anchors share the same fixing bolts and need to be assembled to the lower part of the frame as seen in fig.1.
- 3.3 Hook a metal mounting anchor through each black plastic buckle as shown in fig.2. and compress the open end of the anchor as much as possible by hand.
- 3.4 Push a fixing bolt through the two holes in one of the metal anchors and slide the bolt through one of the holes in the main frame from the outside. Ensure that the black buckle is curving away from the frame.
- 3.5 Slide another metal anchor/plastic buckle assembly over the bolt protruding from the frame ensuring again that the black buckle is curving away from the frame.
- 3.6 Place a washer over the end of the bolt and compress the assembly enough to be able to thread a nut onto the end of the bolt. Using two spanners compress the assembly until the open ends of the fixing anchor are pressed together as shown in fig.1.
- 3.7 Assemble the two remaining metal anchor/plastic buckle assemblies to the other side of the frame in a similar manner.
- 3.8 Unfold the main frame by loosening the two ratchet clamping knobs seen in fig.1 until the clamping cups spring apart. Unfold the frame to the approximate position shown in fig.1. Retighten the clamping knobs so that the clamping cups are firmly together.
- 3.9 The padded support legs should be angled upwards by at least 20° from the horizontal when the frame is attached to the vehicle. The actual angle between the two parts of the frame will vary depending on whether the car is a hatchback, an estate or a saloon with a boot. See figs.7 & 8.
- 3.10 It is important that the fixing straps are threaded the correct way through the black plastic buckles in order for them to remain tight. See fig.2.
- 3.11 Thread a strap through each of the bottom and side buckles as shown in figs.2 & 3. The fixing hooks on the end of the straps should be facing backwards as shown in fig.3.
- 3.12 Attach the remaining two straps to the top anchor fixings as shown in fig.1. The metal clips are spring loaded shut as shown in fig.4. Hold the clip open with your thumb as shown fig.5 and thread the strap through from the back. Release the clip to grip the strap as shown in fig.6. The fixing hook at the end of each strap can be orientated either way round.

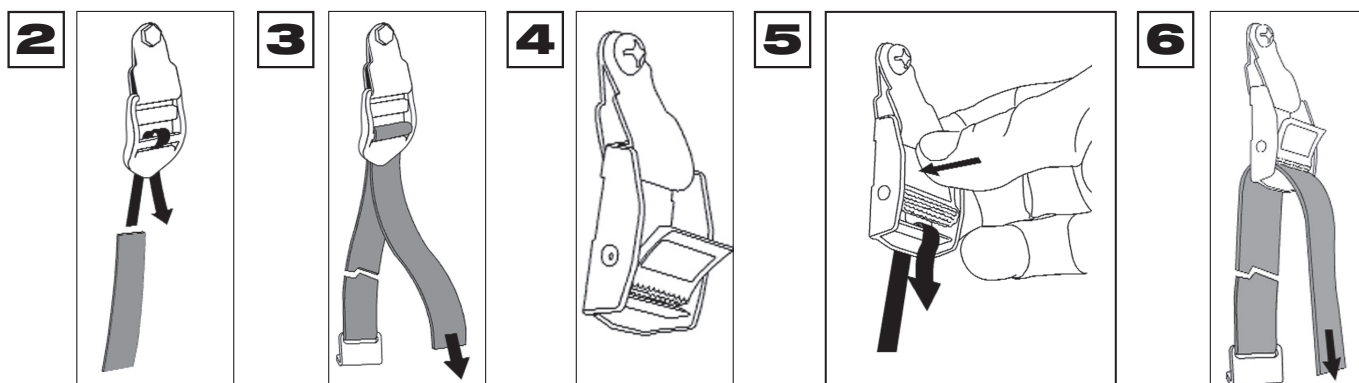
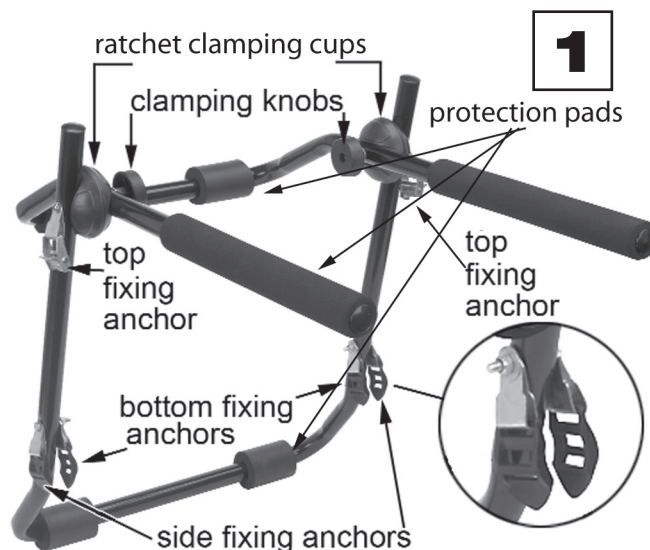



## **4. FIXING CARRIER TO VEHICLE**

### **4.1 PREPARING THE CARRIER**

4.1.1 Position the carrier on the rear of your vehicle and adjust the carrier arms as shown in fig.7 and fig.8.

4.1.2 The arms should be at a minimum angle of 20° above the horizontal. See section 3.1 regarding adjustment of the arms.

4.2 SALOON CARS When securing the carrier to the vehicle ensure that straps are not twisted. Straps must be progressively tightened alternately and equally ensuring the carrier is centrally positioned. Attach straps in order, top, bottom, and then sides as follows:

4.2.1. To fix upper straps to vehicle, we recommend that you hook the straps onto the top edge of the boot lid, see fig.7(T) and adjust the length of the straps to allow the carrier to hang in place at the required height.

4.2.2. Attach the bottom straps to the lower edge of the boot lid, or other adequate securing point on the vehicle bodywork. Equally tighten the straps, see fig.7(B)

4.2.3. Attach the side straps to a suitable position on either side of the boot lid and equally tighten the straps. See fig.7(S).

4.2.4. Adjust all straps to finally position carrier ensuring that the protection pads are firmly in contact with the vehicle bodywork.

4.2.5. Re-check all straps and fully tighten.

4.3. HATCHBACKS & ESTATE CARS When securing the carrier to the vehicle ensure that the straps are not twisted. Straps must be progressively tightened alternately and equally ensuring the carrier is centrally positioned. Attach straps in following order top, bottom and then sides.

4.3.1. To fix upper straps to vehicle, we recommend that you hook the straps onto the top edge of the tailgate, see fig.8(T) and adjust the length of the straps to allow the carrier to hang in place at the required height.

4.3.2. Attach the bottom straps to the lower edge of the tailgate. Equally tighten the straps, see fig.8(B)

4.3.3. Attach the side straps to a suitable position on either side of the rear hatch or door and equally tighten the straps. See fig.8(S).

4.3.4. Adjust all straps to finally position carrier ensuring that the protection pads are firmly in contact with the vehicle bodywork.

4.3.5. Re-check all straps and fully tighten.

## **5. PLACING CYCLES ON CARRIER**

5.1 A maximum of 2/3 bicycles can be placed onto the carrier support arms. Place them in opposite directions. To avoid damage do not position them directly next to the vehicle's exhaust, especially the bicycle tyres. Secure bicycles to the carrier with the straps provided. DO NOT use string or elasticated straps. Ensure that the bicycles, especially the pedals, do not come into contact with the vehicle's bodywork.

5.2. When you have secured the bicycles on the carrier, check and re-tighten all the straps and tie off the surplus lengths of strap for extra security and to prevent the loose ends flapping.

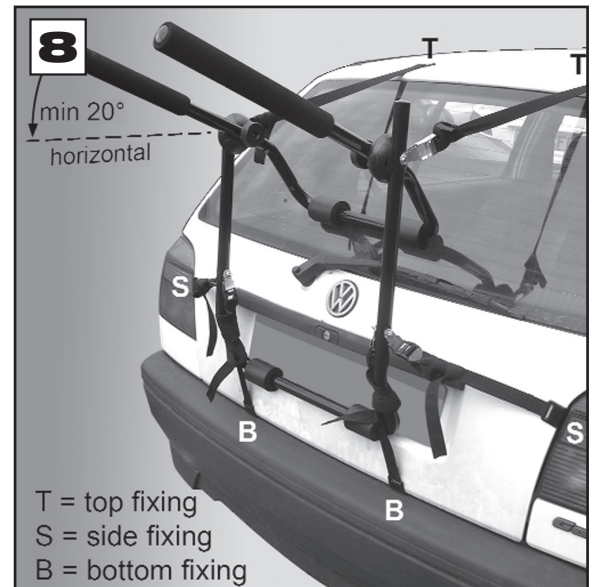
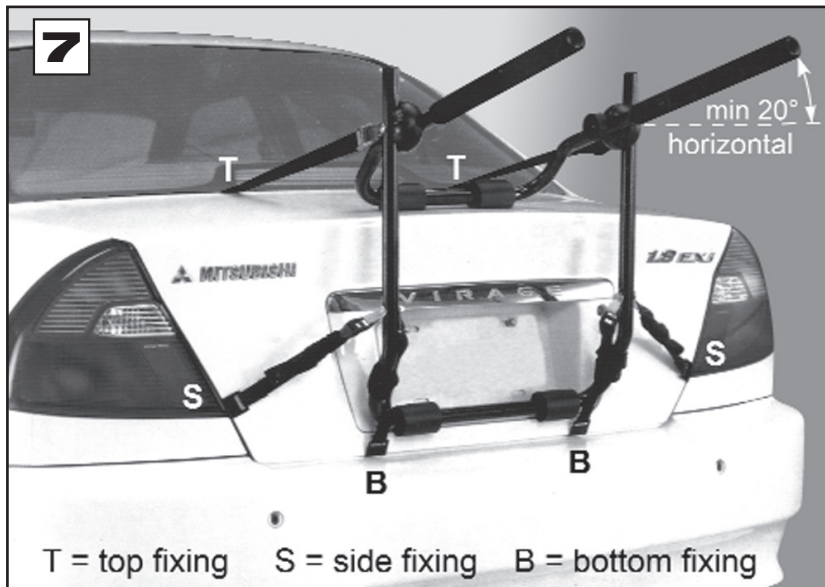

## WARNING!

Remember the driver of the vehicle is responsible for the security and safety of the load carried. Check the tension of all straps and security of the bicycles frequently during your journey. If your lights or number plate are obscured, you must fit an auxiliary number plate and/or lighting system.

**IMPORTANT: No liability is accepted for incorrect use of this product.**

It is recommended that conventional rear mount carriers are not fitted to the following vehicles.

**Sports cars** Due to insufficient strength of lightweight or composite panels, and unsuitable body curvature.

**Cabriolets** Due to fixing points being impeded by hood mechanisms, and reduced space on rear of vehicle.

**Split tailgate** Due to insufficient strength of hinges, and difficulty to fit carriers correctly.

**Side opening tailgate** Due to insufficient strength of hinges, and difficulty to fit carriers correctly.

In most cases an alternative carrying solution can be recommended, such as a roof or tow ball mounted carriers.

IF IN DOUBT ALWAYS CHECK WITH YOUR CAR MANUFACTURER.

81231c  
**ROADSTER**  
*Car Accessories*  
*Quality - that's streets ahead...*



5 038673 812311

ROADSTER B20 3BT UK

# REAR BICYCLE CARRIER